

Compression load cell 50kgf ~ 1tf

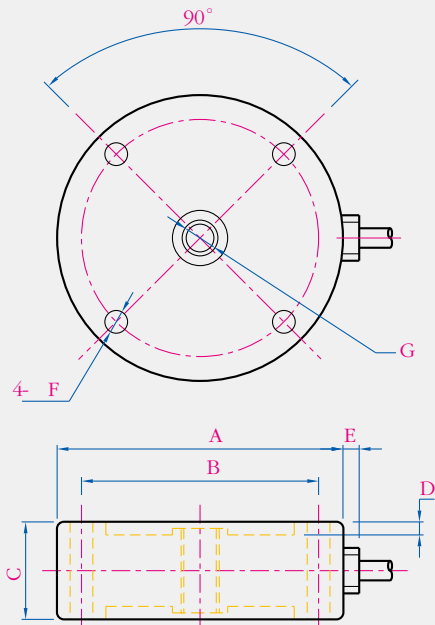

006+ 007

POINT
PC6 Series

Specifications			
Rated Capacity		50, 100, 200, 500, 1tf,	kgf
Rated output		2±0.05	mV/V
Non - linearity		0.05	%
Hysteresis		0.03	%
Repeatability		0.03	%
Creep for 20min		0.03	%
Zero Balance		1	%
Temperature range	Compensated	-10~70	°C
	Safe	-20~80	°C
Temp.effect on	Rated Output	0.03	%/10°C
	Zero balance	0.03	%/10°C
Resistance	Insulation(Min)	2,000	MΩ
	Input	700±7	Ω
Excitation	Output	700±7	Ω
	Recommended	10	V
Safe overload	Maximum	15	V
Electrical connection		150	%
		∅6mm × 4C × 3	M

Features
Pan cake type
Compact sizw with low profile
Protection class IP67

For
Testing & Weighing system
Other force measuring
Tension & Compression application
Tension & Compression application

Material
Paint finished steel

Cable Color Code	
EXC.(+) : RED	EXC.(-) : WHITE
SIG.(+) : GREEN	SIG.(-) : BLUE
SHIELD : YELLOW	

Capacity	∅A	∅B	C	D	E	∅F	G
50, 100, 200,500kgf	88	73	30	2	5	7	M12×1.75P
1tf	88	73	30	2	5	7	M16×2P

[THE ABOVE PRODUCTS IS ORDER PRODUCTION TYPE]